



AIRSTREAM™
SEE MORE DO MORE LIVE MORE

International
CCD Signature Series & Ocean Breeze



SEE MORE DO MORE LIVE MORE

For the carefree traveler with a 21st century aesthetic who loves the Airstream tradition, we offer the Airstream International Travel Trailer, the last word in modern trailer design. Choose from our International CCD Signature Series, designed by award-winning architect and designer Christopher C. Deam, or our International Ocean Breeze line. The sleek reflective exteriors, high-design interiors, and ultramodern amenities tell you right away you're looking at a cutting-edge product.

The Airstream International lines are styled with polished aluminum interiors and intuitive floor plans, and are equipped for your go-anywhere-any-time lifestyle with satellite pre-wire and optional solar package. Their Vista View and wrap-around windows make them always light and airy, and truly bring the outside in. At night, strategically-placed recessed halogen lighting sparkles like starlight across the interior aluminum skin. Every color, shape, surface, and texture contribute to an atmosphere of relaxed modernism. We've combined these attractive features with the engineering passion and almost 80 years of road-tested know-how for which Airstream is justifiably famous, to bring you the Airstream International.

So hitch up and take yourself for a 21st century ride. Drive Western Highway 1 up the length of California to the Lost Coast, or follow Eastern Highway 1 through the fishing towns of Maine to Arcadia National Park. If you have to do a little work, it's easy — send the kids and your spouse to the beach for a while. You can join them once you've e-mailed that proposal. Or park your Ocean Breeze next to Rosarito Beach in Baja for a week, and leave the windows open to catch the ocean breeze.

Like many designers, Chris Deam — a former intern to architect Frank Gehry — was seduced by the Airstream's beauty, purity, and neutrality. Here's his aesthetic take on Airstreams:

“If you look at other travel trailers, the contrast between the trailer and the tow vehicle give the appearance of someone wearing clothes that don't match... It doesn't matter whether [the Airstream] is being towed by a Ford Explorer or a Jaguar XK-E, it stands on its own and doesn't visually fight the vehicle towing it.”

Exterior:

The International CCD Signature Series and the International Ocean Breeze bring a drop-dead gorgeous modern look to the Airstream family. As sleek as every Airstream ever made, the fit and finish are a result of Airstream's long experience on the Interstates and Autobahns, on the most tortuous winding back roads of the world. Our engineers design, refine, and make innovations in collaboration with Airstream owners in many countries, who've been helping Airstream field-test products since the 1930s. The result is the streamlined silver profile recognized around the world.

The International Signature Series and the Ocean Breeze curves are beautiful, but they're not just for looks: the aircraft-industry born, aerodynamically-shaped exterior design lowers wind resistance — requiring less horsepower and approximately 20% less fuel than conventional box trailers. Even the wide picture windows at each end of the International are curved. Monocoque construction, lightweight materials, and a low center of gravity make towing these Airstreams an experience unlike any other travel trailer on the road.

The exterior may be curvy, but we never try to cut any corners. No effort has been spared to create a living space that lets you entertain in style, relax in comfort, and stay on the road for as long as you want to. Like other Airstream Travel Trailers, the Signature Series and the Ocean Breeze are self-sufficient. Its holding tanks, water heater, and furnace are seamlessly integrated into the body of the trailer, to maintain an aerodynamic shape.

Airstream's construction process insures easy serviceability for all components. Everything, from furniture to appliances, is brought in through the door for installation. Since Airstreams can easily last for 50 years or more, this feature makes it relatively easy to redesign the interior to fit your changing needs over the years.

Whether your goals are high adventure or relaxing to the sound of nature, whether you're escaping or joining in, alone or with family, the Signature Series or Ocean Breeze is for you. Nowhere else will you find a home-away-from-home with this perfect balance of luxury and efficiency, and this kind of living history.

Whether you're escaping or joining in, stay on the road as long as you want...



Interior: International CCD Signature Series

Award-winning architect and designer Christopher C. Deam brings together an ideal balance of form and function within the Signature Series streamlined design. This trailer is designed for your aesthetic pleasure with polished aluminum interiors to visually echo the reflective exterior. The aluminum sheen bounces daylight and lamplight all through the interior, opening up the trailer to as much light as possible, and keeping the feeling spacious and clean. Intuitive floor plans and spatial design do away with any sense of clutter without sacrificing charm. Modern color options and fabric choices complement the high contrast aluminum and laminate elements of the Signature Series.



I wanted a subtle but magical connection between the exterior and the interior, the outdoors and indoors. — Chris Deam



International Ocean Breeze

The Ocean Breeze is as light-hearted and appealing as its name, and keeps you in a great mood no matter where you roam. The interior welcomes loads of light, with windows on all four sides and a hall skylight. The Ocean Breeze's interior appointments come in watery, oceanic colors, to reinforce the feeling of being oceanside. In addition to its aesthetic charm and peaceful aura, the Ocean Breeze provides all the functionality and quality Airstreams are known for. Even when you're parked in the Black Rock desert, experiencing your first "Burning Man," you'll swear you can still faintly hear the surf pounding and smell a little salt on the breeze.



Both the Ocean Breeze and Signature Series offer you an entertainment paradise, with a stellar sound system and optional flat-panel televisions. Backlit overhead storage compartments are closed with translucent sliding doors, continuing the sensation of lightness and space inside the trailer. Streamlined kitchens are a great place to prepare anything from sashimi to cioppino, or to just stir up a bowl of oatmeal — with their top-of-the-line sealed-burner range, stainless steel sink, and chrome fixtures. Deluxe bedroom mattresses ensure you a good night's sleep. While underbed storage, as well as wardrobe space, give you plenty of room to store your belongings.

Inside an International, quality and innovation abound. The Ocean Breeze and Signature Series come with aluminum-framed windows that are



riveted into the shell. The windows utilize tempered safety glass with tint and UV inhibitors. Hidden inside the International's walls, but crucial for traveling comfort, is our residential-type 2.5" fiberglass batten insulation, which keeps the interior cool in the summer, warm in the winter, and quiet all year around. All Airstreams are thoroughly insulated, including the floor and holding tanks.

Hitch up, and bring your 21st century design aesthetic with you. The Signature Series or Ocean Breeze will carry you into the future with ease, sophistication, and a long history of excellence.

16' International Signature Series & Ocean Breeze

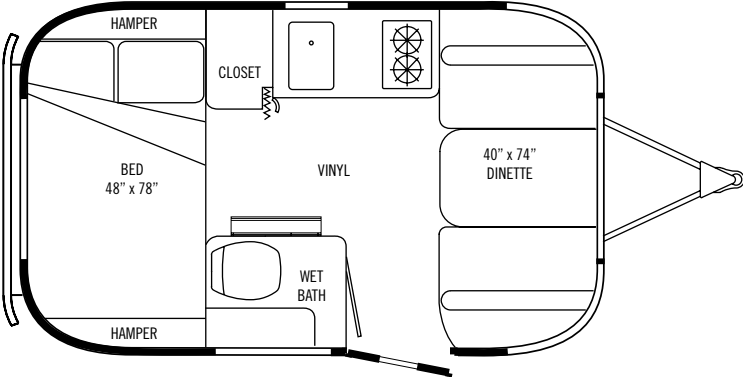

19' International Signature Series & Ocean Breeze

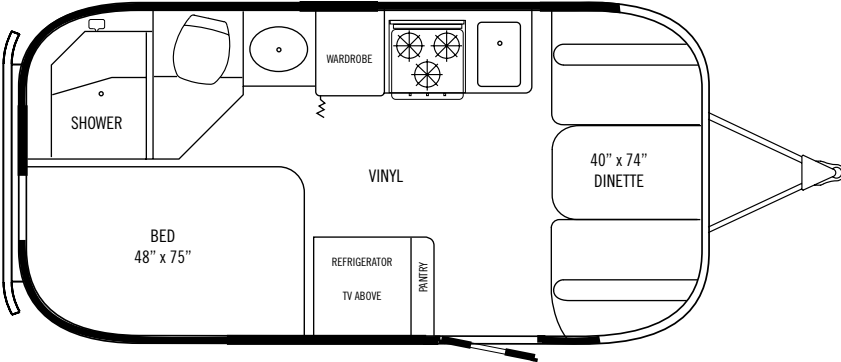

23'D International Signature Series & Ocean Breeze

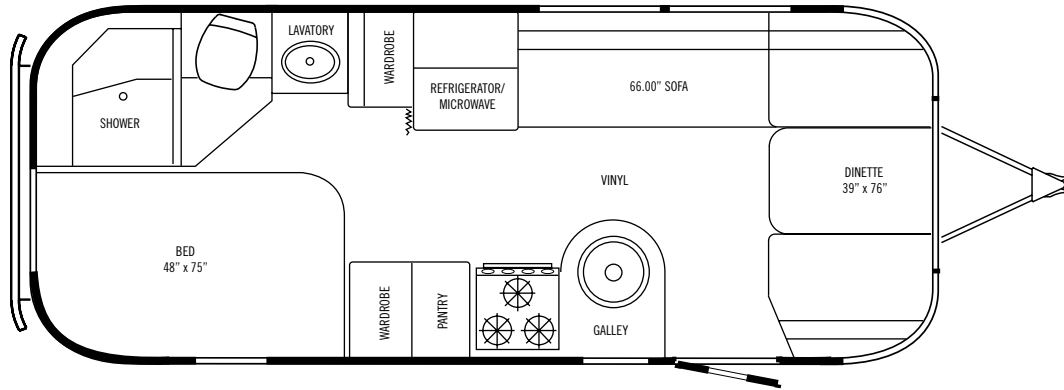

25'SS International Signature Series & Ocean Breeze

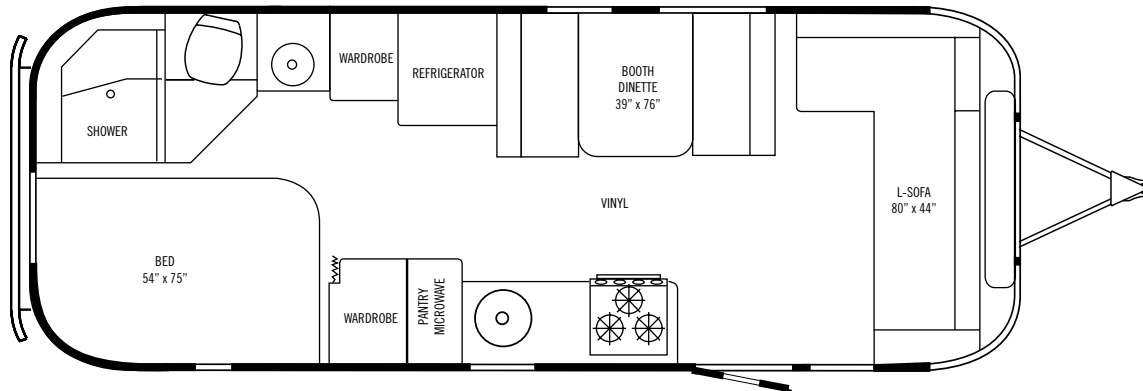

International CCD Signature Series & Ocean Breeze Floorplans

25'FB International Signature Series & Ocean Breeze

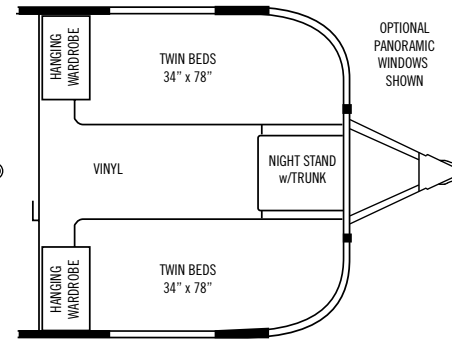
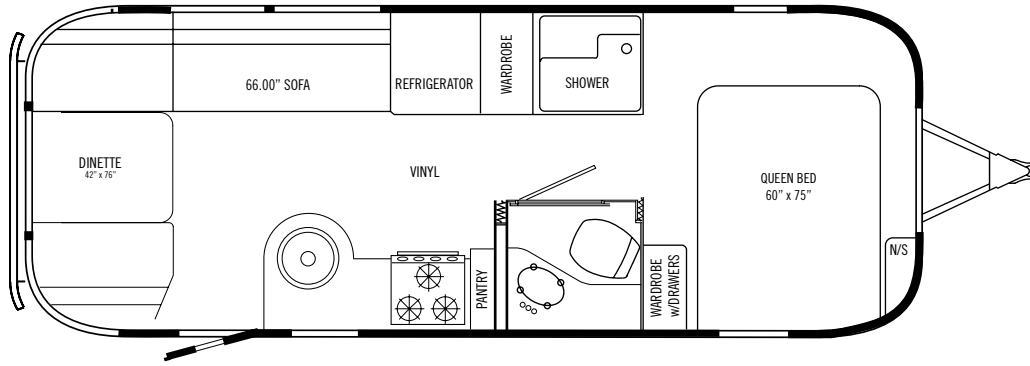

27'FB International Signature Series & Ocean Breeze

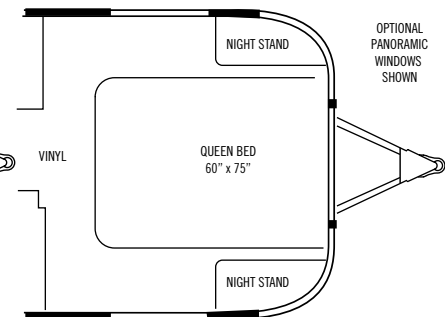
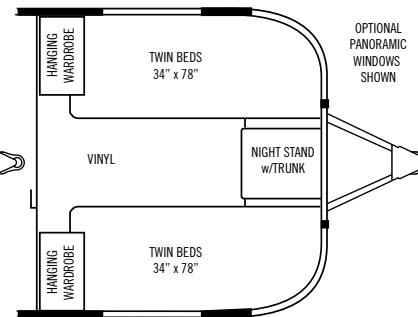
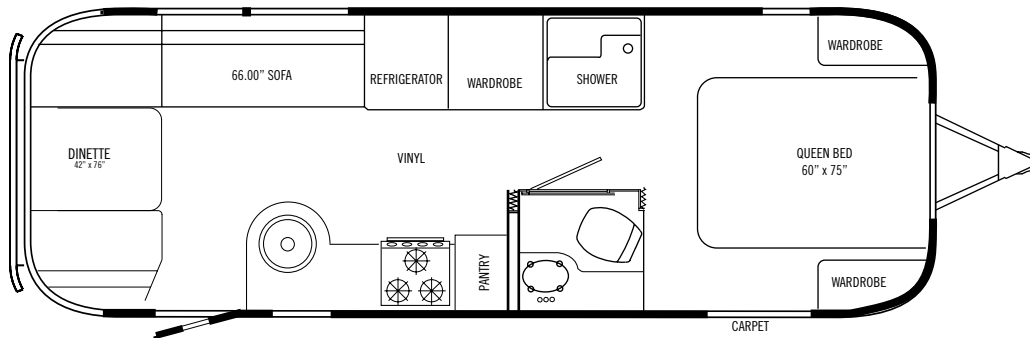

International CCD Signature Series & Ocean Breeze Floorplans

28' International Signature Series & Ocean Breeze

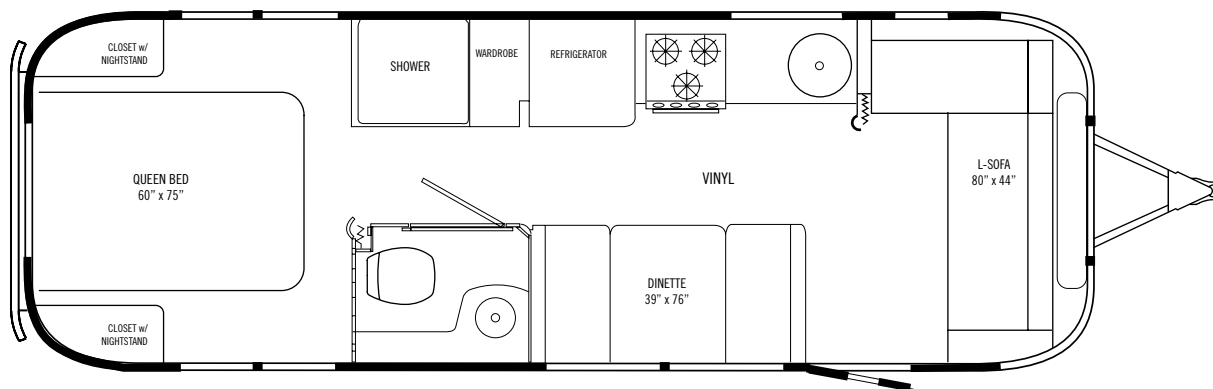

See www.airstream.com for more detailed specifications and options

International CCD Signature Series Specifications

	16' Internat.	19' Internat.	23'D Internat.	25'SS Internat.	25'FB Internat.	27'FB Internat.	28' Internat.
Actual Length	16'7"	19'2"	23'0"	25'11"	25'11"	28'0"	27'11"
Width Exterior	8'	8'	8'	8'5.5"	8'5.5"	8'5.5"	8'5.5"
Width Interior	7'7"	7'7"	7'7"	8'1"	8'1"	8'1"	8'1"
Height Exterior w/o Air Conditioner	8'8"	8'9"	8'9"	8'11"	8'11"	8'11"	8'11"
Height Exterior w/Air Conditioner	9'4"	9'5"	9'5"	9'7"	9'7"	9'7"	9'7"
Height Interior w/o Air Conditioner	6'7"	6'7"	6'7"	6'7.5"	6'7.5"	6'7.5"	6'7.5"
Height Interior w/Air Conditioner	6'4.5"	6'4.5"	6'4.5"	6'5"	6'5"	6'5"	6'5"
Hitch Ball Height	18"	17.25"	17.75"	17.75"	17.75"	17.75"	17.75"
3500 lb. GVWR	Std	N/A	N/A	N/A	N/A	N/A	N/A
4300 lb. GVWR	CSA	N/A	N/A	N/A	N/A	N/A	N/A
4500 lb. GVWR	N/A	Std	N/A	N/A	N/A	N/A	N/A
5000 lb. GVWR	N/A	CSA	N/A	N/A	N/A	N/A	N/A
5600 lb. GVWR	N/A	N/A	N/A	N/A	N/A	N/A	N/A
6000 lb. GVWR	N/A	N/A	Std	N/A	N/A	N/A	N/A
6300 lb. GVWR	N/A	N/A	CSA	N/A	N/A	N/A	N/A
7000 lb. GVWR	N/A	N/A	N/A	Std	N/A	N/A	N/A
7300 lb. GVWR	N/A	N/A	N/A	N/A	Std	N/A	Std
7600 lb. GVWR	N/A	N/A	N/A	N/A	N/A	Std	N/A
Furnace	12000 BTU	16000 BTU	25000 BTU	25000 BTU	25000 BTU	25000 BTU	30000 BTU
Water Tank w/Drain Valve, Gallons	23	23	30	39	39	39	39
Black Water Tank, Gallons	N/A	18	18	18	39	39	35
Combination Black & Gray Tank	21	N/A	N/A	N/A	N/A	N/A	N/A
Gray Water Tank, Gallons	N/A	21	21	39	37	37	37
UBW (Unit Base Weight) w/o Options or Fluids	2,825	3,575	4,695	5,145	5,410	5,813	5,440
Hitch Weight, w/o Options or Variable Wt.	430	510	700	740	820	790	880
NCC (Net Carrying Capacity) w/o Options + Personal Cargo + Fluids	675	925	1,305	1,855	1,890	1,787	1,860
Sleeping Capacity	3	3-4	4-5	5-6	4-6	4-6	4-6
Décor Interior							
Cilantro	Opt	Opt	Opt	Opt	Opt	Opt	Opt
Paprika	Opt	Opt	Opt	Opt	Opt	Opt	Opt
Signature Series Interior (Wenge Laminate)	Std	Std	Std	Std	Std	Std	Std

Product information, specifications, and photography in this brochure were as accurate as possible at time of printing. Photographs may contain some features that are optional on your vehicle. Since we continually strive to improve our products, actual products may differ. Prices and specifications are subject to change without notice. All capacities are approximate and dimensions are nominal. Some features or options may be different or unavailable in Canada.

Vehicle Loading — Every effort has been made to provide the greatest number of options for the recreation vehicle owner. Along with these choices comes the responsibility to manage the loads that are imposed by the choices so that they remain within the manufacturer's specified chassis weight limits. Do not overload the recreation vehicle.

Dry Weights — Based on standard features; optional equipment not included. Net carrying capacity (NCC) determined by subtracting unloaded vehicle weight (UVW) from gross vehicle weight (GVWR) and includes fluids, options, and cargo. Liquid capacities and weights are approximations only.

Warning — This information is intended as a guide only. Weights of individual vehicles may vary. Consult your owner's manual for complete loading, weighing, and towing instructions.

See www.airstream.com for more detailed specifications and options

International Ocean Breeze Specifications

	16' Internat.	19' Internat.	23'D Internat.	25'SS Internat.	25'FB Internat.	27'FB Internat.	28' Internat.
Actual Length	16'7"	19'2"	23'0"	25'11"	25'11"	28'0"	27'11"
Width Exterior	8'	8'	8'	8'5.5"	8'5.5"	8'5.5"	8'5.5"
Width Interior	7'7"	7'7"	7'7"	8'1"	8'1"	8'1"	8'1"
Height Exterior w/o Air Conditioner	8'8"	8'9"	8'9"	8'11"	8'11"	8'11"	8'11"
Height Exterior w/Air Conditioner	9'4"	9'5"	9'5"	9'7"	9'7"	9'7"	9'7"
Height Interior w/o Air Conditioner	6'7"	6'7"	6'7"	6'7.5"	6'7.5"	6'7.5"	6'7.5"
Height Interior w/Air Conditioner	6'4.5"	6'4.5"	6'4.5"	6'5"	6'5"	6'5"	6'5"
Hitch Ball Height	18"	17.25"	17.75"	17.75"	17.75"	17.75"	17.75"
3500 lb.GVWR	Std	N/A	N/A	N/A	N/A	N/A	N/A
4300 lb.GVWR	CSA	N/A	N/A	N/A	N/A	N/A	N/A
4500 lb.GVWR	N/A	Std	N/A	N/A	N/A	N/A	N/A
5000 lb.GVWR	N/A	CSA	N/A	N/A	N/A	N/A	N/A
5600 lb.GVWR	N/A	N/A	N/A	N/A	N/A	N/A	N/A
6000 lb.GVWR	N/A	N/A	Std	N/A	N/A	N/A	N/A
6300 lb.GVWR	N/A	N/A	CSA	N/A	N/A	N/A	N/A
7000 lb.GVWR	N/A	N/A	N/A	Std	N/A	N/A	N/A
7300 lb.GVWR	N/A	N/A	N/A	N/A	Std	N/A	Std
7600 lb.GVWR	N/A	N/A	N/A	N/A	N/A	Std	N/A
Furnace	12000 BTU	16000 BTU	25000 BTU	25000 BTU	25000 BTU	25000 BTU	30000 BTU
Water Tank w/Drain Valve, Gallons	23	23	30	39	39	39	39
Black Water Tank, Gallons	N/A	18	18	18	39	39	35
Combination Black & Gray Tank	21	N/A	N/A	N/A	N/A	N/A	N/A
Gray Water Tank, Gallons	N/A	21	21	39	37	37	37
UBW (Unit Base Weight) w/o Options or Fluids	2,825	3,575	4,695	5,145	5,410	5,813	5,440
Hitch Weight, w/o Options or Variable Wt.	430	510	700	740	820	790	880
NCC (Net Carrying Capacity) w/o Options + Personal Cargo + Fluids	675	925	1,305	1,855	1,890	1,787	1,860
Sleeping Capacity	3	3-4	4-5	5-6	4-6	4-6	4-6
Ocean Breeze Interior Décor Includes:	Std	Std	Std	Std	Std	Std	Std
- Beach Theme							
- Premium Laminates (White, Almond, And Kaleidoscope)							
- Bamboo Detailing On Handles, Lampshades, And Rooflockers							
- Decorative Light Fixtures							
- Tropical Patterned Draperies							
- Tan Flooring							
- Blue/White Stripe Fabric							
- Suede Accent Cushions							
- Classic Diner Tabletop Trimmed w/Aluminum Border							
- Blue & White Striped Patio Awning, (1) Roadside Window Awning, & (1) Rear Window Awning							
- (Window Awnings N/A On 16')							
- Hinged Bath Door With Portal Window							
- Refrigerator Insert - Aluminum							

See www.airstream.com for more detailed specifications and options



Designed to be part of your life

AIRSTREAM 2008 See the International online at www.Airstream.com

AIRSTREAM™

419 West Pike Street
P.O. Box 629
Jackson Center, Ohio 45334
Tel: 937-596-6111
www.airstream.com

All content and images copyright © Airstream 2007
Selected photographs by Larry McCay www.larrymccay.com
Design by Velocity7 www.velocity7.com

THOR
INDUSTRIES, INC.